

## LATEST NEWS FROM MENTAL HEALTH DEVELOPMENT IN MOUNT VIEW STREET

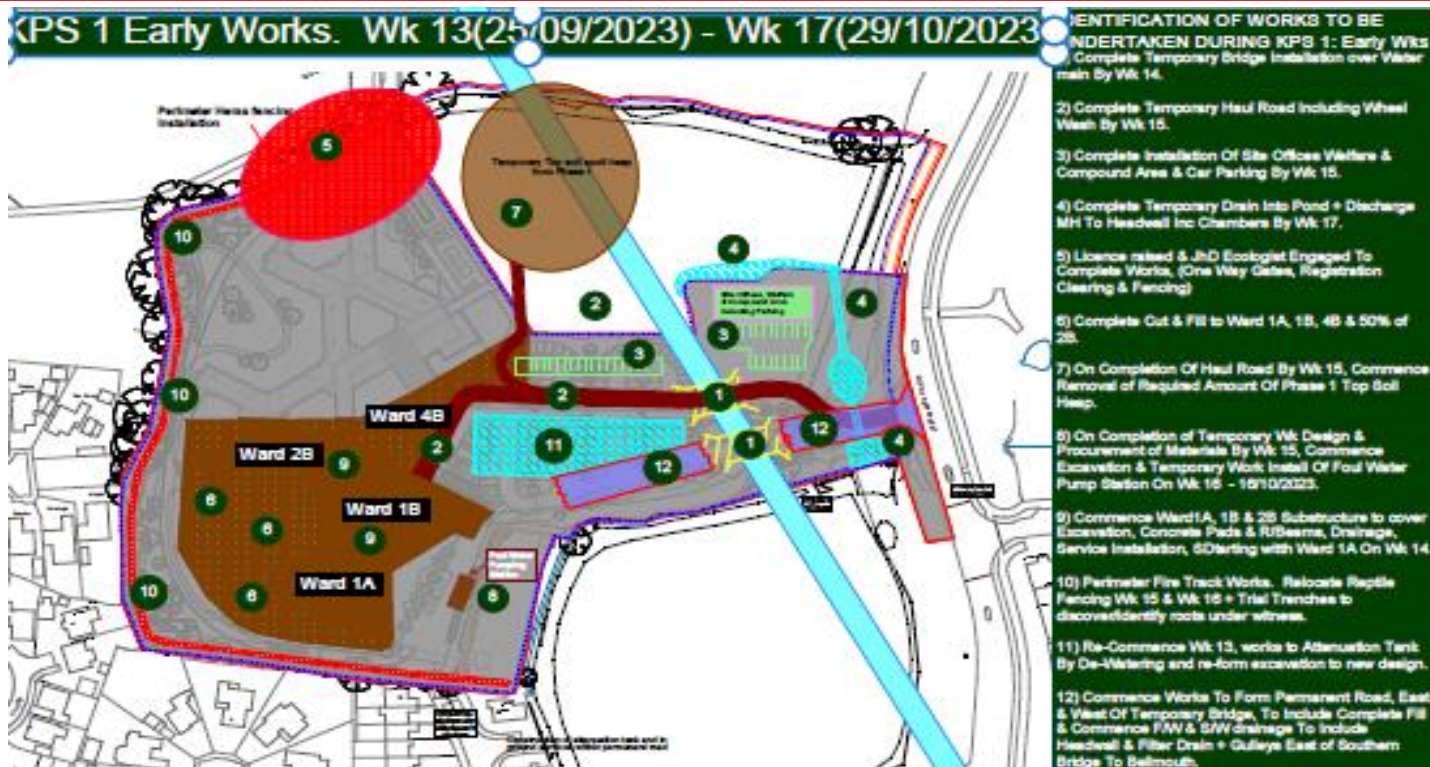

### Plan of Works for the coming Month.

During the last month, we have started work on laying the foundations for the new building.

We have also installed the welfare buildings for everyone working on site. This includes meeting rooms, small eating area and toilet and washing facilities.

You will have seen that we have also put up hoardings on Mount View Street. These will not only carry statutory notices - but will also include a community information board as well as artistic displays to make the hoardings more attractive.



## Events

On Thursday 5 October, we held a public meeting for local people at The Pelham community hub in Holliers Hill.

More than 30 of you attended and we responded to a wide range of questions about the development. One particular area of interest was the proposed secondary emergency access into the site. We let people know that our preferred option is to create a second entrance in Mount View Street and the access will run round the outside edge of the site.

This has not been confirmed yet as we still need the relevant permissions from Rother District. We will keep you posted on progress.

## Community activity

We visited Ore Valley College in Hastings recently to talk to students about construction apprenticeship opportunities. This visit was well received.

If you know of anyone interested in apprenticeships or workplaces on site then please let us know.

We are continuing to liaise with Rother District Council about our *Local Employment and Skills Plan* which needs to be implemented as part of the planning permission for the development

## Next Update in November



## Site operations hours:

8am to 6pm

### Kier project office

Mount View Street, TN40 2AF.

### Kier local office

Platinum House, Sussex Manor Business Park,  
Gatwick Road, Crawley, RH10 9NH

## Keeping you informed:

To find out more now, then please check out the Sussex Partnership NHS Foundation Trust website:

[New Mental Health Hospital for Bexhill: Redesigning Inpatient Services: East Sussex \(RIS:ES\) | Sussex Partnership NHS Foundation Trust](#)

Or Email the Trust at:

[esxccg.eastsussex.mh@nhs.net](mailto:esxccg.eastsussex.mh@nhs.net)

## Our QR Code for more information:



Or you can email Kier at:

[RISES.community@kier.co.uk](mailto:RISES.community@kier.co.uk)

Thank you!